



Drive-In Racking



Low cost, high-density storage

For cost-effective, high-density storage Drive-in / Drive-thru racking is often the choice. Requiring fewer aisles, and providing better cube utilization than selective racks, drive-in / drive-thru rack allow you to store up to 75% more pallets than with selective racking.

Forklifts drive directly into the rack to allow storage of two or more pallets deep. Because of this, drive-in / drive-thru racks are subject to more abuse than any other rack structure. Steel King's drive-in rack is engineered and manufactured to better stand up to the punishment, allowing us to become the market leader in drive-in racking.

- Low cost, high-density storage
- Unlimited storage depth
- Ideal for high-traffic and cooler / freezer installations
- Optional offset leg design (shown at left)

Drive-in Concept

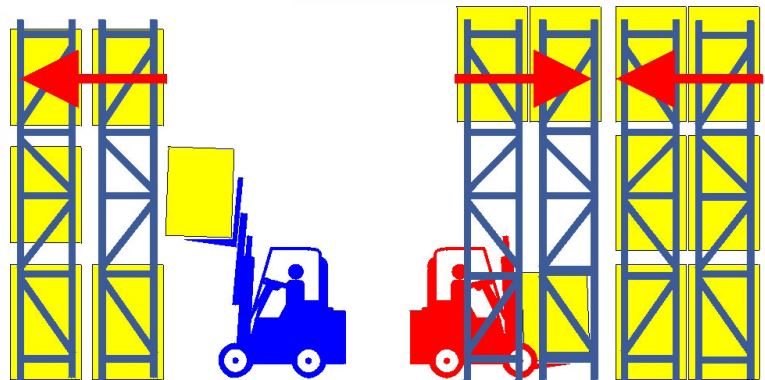

Steel King offers drive-in / drive-thru racking with either SK3000® structural, or SK2500® bolted tubular uprights. Please see product brochures for more details.



Better, by Design

Steel King's drive-in / drive-thru features and benefits include:

- Ideal solution for large volume storage of like product
- Welded frame construction delivers high rigidity and strength
- Drive-In rack uses a common entry and exit
- Drive-Thru rack has a separate entry and exit
- Use of structural or roll-formed components with many options
- Reduces space costs by storing more loads in less space

Additionally, Steel King offers a wide variety of safety options for drive-in racking including:

- Offset leg (shown at left)
- Heavy horizontal
- Reinforcement posts
- Welded-angle column protectors
- Free-standing column protectors
- Wider footplates
- Seismic designs
- Steel Guard® protective railing

Heavy Horizontal

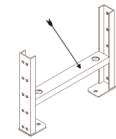

Reinforced Post

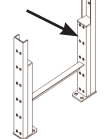

Welded Angle Column Protector

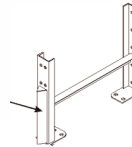

Free-Standing Column Protector

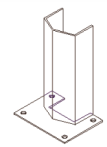

Load Rail Design

Steel King's drive-in load rails are constructed of durable structural angle steel, providing increased strength and abuse resistance. Standard features include:

1. Structural angle rails "guide" pallets, ease of use and durability
2. Flared rail entry ends allow easy bay access
3. Space-saver low profile arms increase clearance and decrease possible product damage
4. Welded rail stops prevent loads from being pushed off and improve safety
 - 2" vertical adjustability
 - Welded aisle-load arms to eliminate hazardous load projections into aisles
 - Grade 5 Hardware

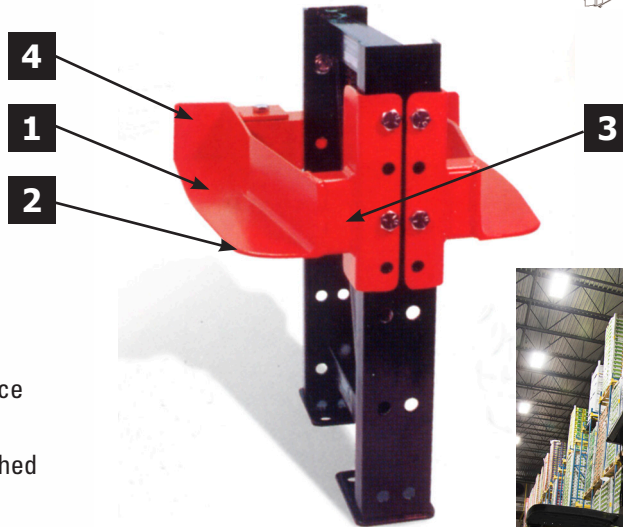

© Steel King Industries, Inc. 2016